

**Fig No: FPC-800**

**1/2" ~ 2" DN15 ~ DN50**

**Features :**

800Lb Forged steel check valves are available in two bonnet designs. The first design is the Bolted Bonnet, With male-female joint, spiral wound gasket, made in F304L/graphite. Ring joint gasket are also available on request. The second design is the welded bonnet, with a threaded and seal welded joint, On request a full penetration strength welded joint is available.

**Check valve Design Construciton and Specifications :**

Check vales conform to MSS-SP-118 and ASME B16.34.  
Each are tested according to API598  
Marking is per MSS SP-25.

**Construciton is as follows :**

- Full Port or Conventional Port
- Piston check
- Spring available on request
- Bolted bonnet with spiral-wound gasket, threaded and seal welded bonnet or threaded and pressure seal bonnet
- Socket weld Ends to ASME B16.11
- Screwed Ends (NPT) to ANSI/ASME B1.20.1

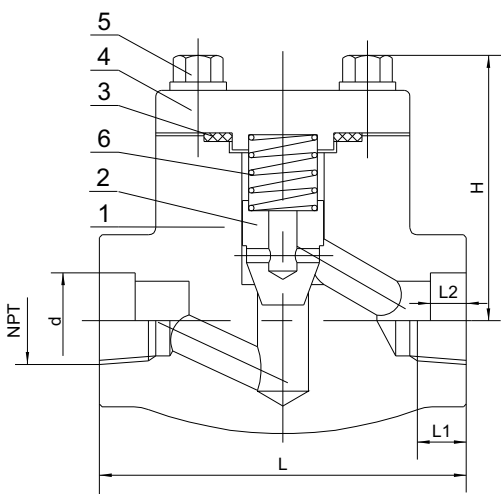

**DIMENSIONS**

unit:mm

| NPS   | d    | L2 | NPT   | L1 | L   | H   |
|-------|------|----|-------|----|-----|-----|
| 1/2   | 21.8 | 10 | 1/2   | 15 | 76  | 76  |
| 3/4   | 27   | 13 | 3/4   | 18 | 92  | 92  |
| 1     | 34   | 13 | 1     | 18 | 106 | 106 |
| 1-1/4 | 42.5 | 13 | 1-1/4 | 19 | 120 | 120 |
| 1-1/2 | 48.5 | 13 | 1-1/2 | 19 | 140 | 140 |
| 2     | 61   | 16 | 2     | 25 | 144 | 144 |

**MATERIALS LIST**

| NO | Name        | MATERIAL      |               |         |
|----|-------------|---------------|---------------|---------|
| 1  | BODY(SEAT)  | A105+ER410    | F304(L)       | F316(L) |
| 2  | PISTON DISC | A182 F6       | F304(L)       | F316(L) |
| 3  | GASKET      | F304+GRAPHITE | F316+GRAPHITE |         |
| 4  | BONNET      | A105          | F304(L)       | F316(L) |
| 5  | BOLT        | A193 B7       | A193 B8       |         |
| 6  | SPRING      | F304          | F316          |         |

Other Materials Also Available On Requested