



Three Piece Trunnion mounted type Metal Seated Flanged Ball Valves, Full Bore, ANSI Class 300

Fig No: MD-54Q-300 Full Bore
6"~ 12" DN80 ~ DN300



Three pieces body design, trunnion mounted type
 Blowout - proof stem
 All valves with graphite packing and backup seal are inherently fire safe
 Ball and seats lapped for optimum performance and tight shutoff
 Wall thickness : AMSE/ANSI B16.34 CLASS 300 full port only
 Flanged dimensions : ANSI B16.5 Class 300
 Face to Face : ANSI B16.10 Class 300 RF
 Pressure-Temperature Rating : ASME B16.34
 Tightness rates : ΔP : ASME / FCI 70-2 Class IV
 Temperature limitation $\leq 350^{\circ}C$ for grafoil seal kits
 $\leq 200^{\circ}C$ for viton seal kits

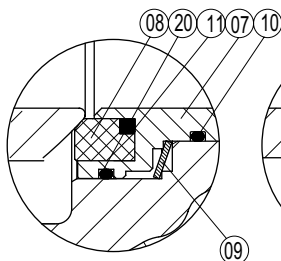
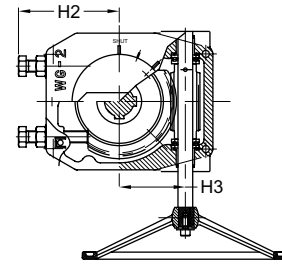
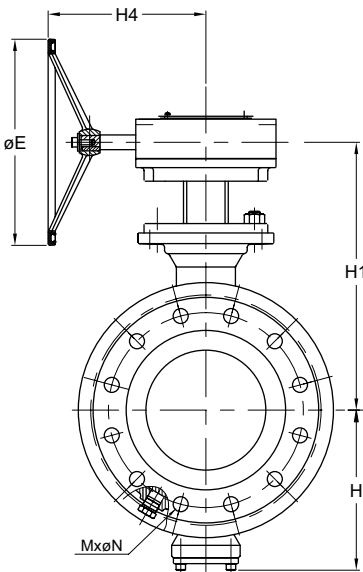
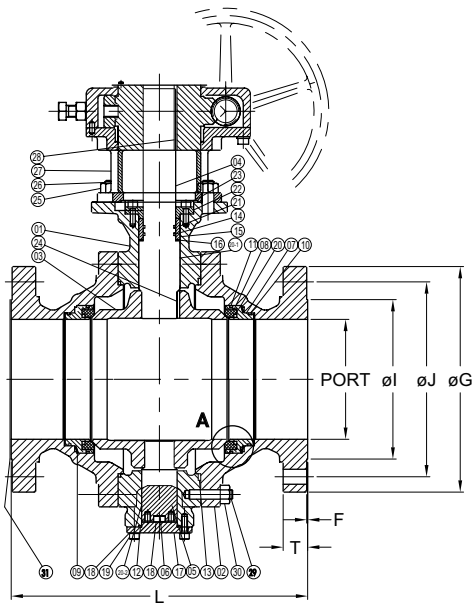

DETAIL A
VITON $\leq 200^{\circ}C$

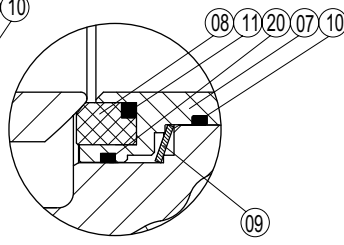

DETAIL A
GRAFOIL $\leq 350^{\circ}C$

DIMENSIONS

unit:mm

SIZE	PORT	L	øE	H	H1	H2	H3	H4	øG	øJ	øI	T	F	M	øN	W/G. TYPE
6"	150.0	403.4	350.0	210.0	380.0	80.0	81.0	220.0	317.5	269.9	215.9	36.6	1.6	12	22.2	WG1
8"	200.0	501.7	350.0	275.0	430.0	80.0	81.0	220.0	381.0	330.2	269.8	41.3	1.6	12	25.4	WG1
10"	254.0	568.5	457.0	330.0	480.0	120.0	112.0	310.0	444.5	387.4	323.9	47.6	1.6	16	28.6	WG1
12"	300.0	647.7	457.0	370.0	554.0	120.0	112.0	310.0	520.7	450.9	381.0	50.8	1.6	16	31.8	WG2

MATERIALS LIST

NO.	PARTS NAME	MATERIALS		
1	BODY	ASTM A216-WCB	ASTM A351-CF8	ASTM A351-CF8M
2	END CAP	ASTM A216-WCB	ASTM A351-CF8	ASTM A351-CF8M
3	BALL	ASTM A351-CF8+HCr		ASTM A351-CF8M+HCr
4	STEM	ASTM A276-410	ASTM A276-304	ASTM A276-316
5	LOWER STEM	ASTM A276-410	ASTM A276-304	ASTM A276-316
6	BOTTOM BEARING	P-H3(PTFE+MOS2)		
7	SEAT RETAINER	ASTM A105+Cr.PLT.	ASTM A182-F304	ASTM A182-F316
8	SEAT	ASTM A276-304+STL#6	ASTM A276-304+STL#6	ASTM A276-304+STL#6
9	SPRING	ASTM A240-301		
10	O RING	Viton (or Grafoil)		
11	O RING	Viton (or Grafoil)		
12	O RING	Viton (or Grafoil)		
13	BODY SEAL	Viton (or Grafoil)		
14	O RING	Viton (or Grafoil)		
15	O RING	Viton (or Grafoil)		
16	THRUST WASHER	P-H3(PTFE+MOS2)		
17	BOTTOM COVER	ASTM A105	ASTM A240-304	ASTM A240-316
18	SPRING WASHER	ASTM A510-1060	S.S	S.S
19	HX. SOCKET CAP SCREW	ASTM A193-B7	ASTM A193-8	ASTM A193-8
20	SEAT GASKET	P-H3(PTFE+MOS2)		
20-1	STEM BUSHING	P-H3(PTFE+MOS2)		
20-2	STEM BEARING	P-H3(PTFE+MOS2)		
21	GLAND	ASTM A276-304		ASTM A276-316
22	GLAND FLANGE	ASTM A216WCB	ASTM A351-CF8	ASTM A351-CF8M
23	GLAND BOLT	ASTM A193-B7	ASTM A193-B8	ASTM A193-B8
24	KEY	ASTM A276-316		
25	HX. NUT	ASTM A194-2H	ASTM A194-8	ASTM A194-8
26	STUD	ASTM A193-B7	ASTM A193-B8	ASTM A193-B8
27	WORM GEAR UNIT	ASTM A536/A216-WCB		
28	KEY	ASTM A108-1045		
29	STUD	ASTM A193-B7	ASTM A193-B8	ASTM A193-B8
30	BOLT NUT	ASTM A194-2H	ASTM A194-8	ASTM A194-8
31	END COVER	WOOD / P.E.		