

Fig No. : V-105F Full Bore
1/2"~ 4" DN15~ DN100



Features :

- Investment Cast Components,
- Length according to DIN 3202 F1
- Blow - out - proof stem design , Bottom entry stem
- For General Chemical and Industrial application
- In - line maintenance
- Carbon steel or super Alloy upon request

Standard Compliance :

- Body wall thickness : EN 12516-1/2/3
- Flange : EN 1092-1 PN40
- Face to Face : DIN 3202 F1
- Body material : EN1503-1
- Pressure testing : EN 12266

Specifications :

- End connection : Flanged end
- Working Pressure : 40 Bar (CWP)
- Temperature Range : -4 to 356°F (-20 to 180°C)

MATERIALS LIST

NO.	PART NAME	MATERIAL
1	BODY	1.4408 / EN1503-1
4	BALL	CF8M / EN1503-2
5	STEM	SS316
9	END CAP	1.4408 / EN1503-1
12	SEAT	PTFE.
13	THRUST WASHER	PTFE.
14	STEM PACKING	PTFE.
16	GLAND NUT	SS304
19	HANDLE	SS304
21	HANDLE COVER	PLASTIC
23	HANDLE WASHER	SS304
24	HANDLE NUT	SS304
28	LOCKING DEVICE	SS304 (OPTION)
35	BODY BOLT	SS304
36	BOLT WASHER	SS304
37	BOLT NUT	SS304

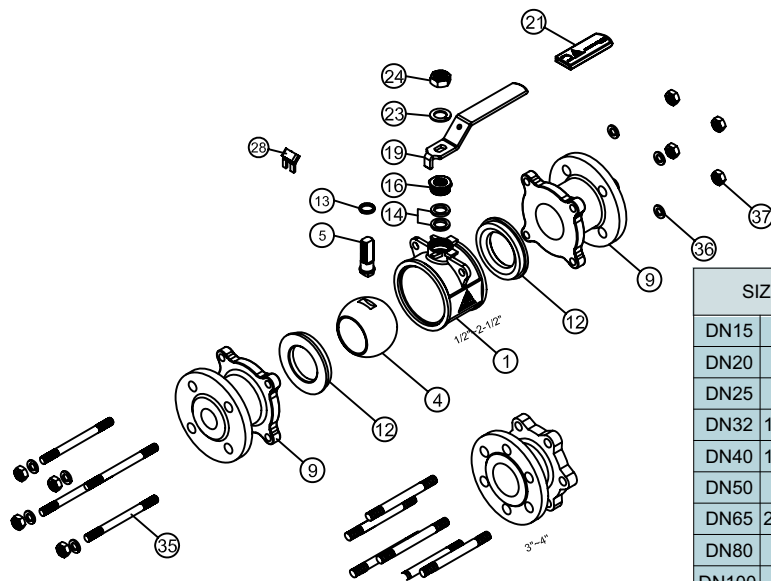
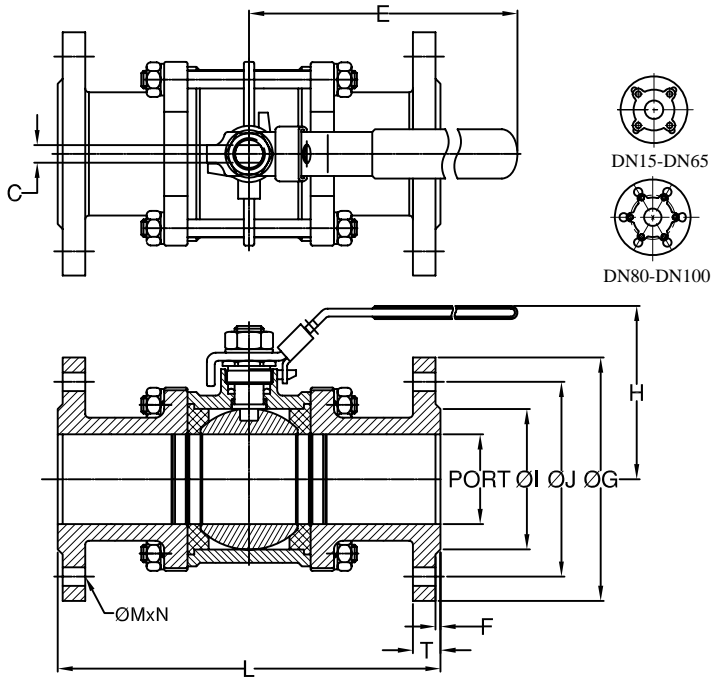

DIMENSIONS

mm

SIZE	PORT	L	H	E	øI	øJ	øG	T	F	øM	N	C	
DN15	1/2"	15.0	130.0	58.5	122.9	45.0	65.0	95.0	16.0	2.0	14.0	4	6.5
DN20	3/4"	20.0	150.0	61.0	122.9	58.0	75.0	105.0	18.0	2.0	14.0	4	6.5
DN25	1"	25.0	160.0	68.0	144.9	68.0	85.0	115.0	18.0	2.0	14.0	4	8.0
DN32	1-1/4"	32.0	180.0	73.5	144.9	78.0	100.0	140.0	18.0	2.0	18.0	4	8.0
DN40	1-1/2"	38.0	200.0	83.2	188.9	88.0	110.0	150.0	18.0	3.0	18.0	4	9.7
DN50	2"	50.0	230.0	91.0	188.9	102.0	125.0	165.0	20.0	3.0	18.0	4	9.7
DN65	2-1/2"	65.0	290.0	130.3	255.3	122.0	145.0	185.0	22.0	3.0	18.0	8	12.0
DN80	3"	80.0	310.0	138.5	260.8	138.0	160.0	200.0	24.0	3.0	18.0	8	12.0
DN100	4"	100.0	350.0	216.5	260.8	162.0	190.0	235.0	24.0	3.0	22.0	8	12.0

FACE TO FACE : DIN 3202 F1
 FLANGE DIMENSION : DIN2501 PN40