

**Fig no. VF-52**

**1/2" - 6" DN15 ~ DN150**



**Feature :**

Investment Casting Component  
ISO 5211 mounting Flange  
Blow-out-proof stem, Anti-Static Design  
For Flow and Steam Control  
Carbon steel or Super Alloy upon request

**Standard Compliance:**

Body wall thickness : B16.34  
Face to Face : ANSI B16.10 Class 150  
Flange Dimension : ANSI B16.5 Class 150  
Finish : 125- 250 AARH  
Body Material : ASTM A351  
Pressure testing : EN12266

**Standard Compliance:**

End connection : Flange RF  
Working pressure : 275 psi ( CWP )  
Temperature : -20 ~ 220° C

**MATERIALS LIST**

| NO.  | PART NAME      | MATERIAL          |
|------|----------------|-------------------|
| 1    | BODY           | ASTM A351 Gr.CF8M |
| 4    | BALL           | ASTM A351 Gr.CF8M |
| 5    | STEM           | SS316             |
| 9    | INSERT         | ASTM A351 Gr.CF8M |
| 11   | BODY SEAL      | PTFE.             |
| 12   | SEAT           | 50%SS+50%PTFE.    |
| 13   | THRUST WASHER  | PTFE.             |
| 14   | STEM PACKING   | PTFE.             |
| 15   | GLAND          | SS304             |
| 17   | GLAND PACKING  | SS304             |
| 19   | HANDLE         | FCD45             |
| 19-1 | HANDLE PIPE    | FCD45             |
| 28   | STOP PLATE     | SS304             |
| 35   | STUD           | SS304             |
| 37   | BOLT NUT       | SS304             |
| 41   | SNAP RING      | SS304             |
| 42   | GLAND BOLT     | SS304             |
| 50   | HANDLE ADAPTER | ASTM A351 Gr.CF8  |
| 56   | BEARING        | PTFE.             |

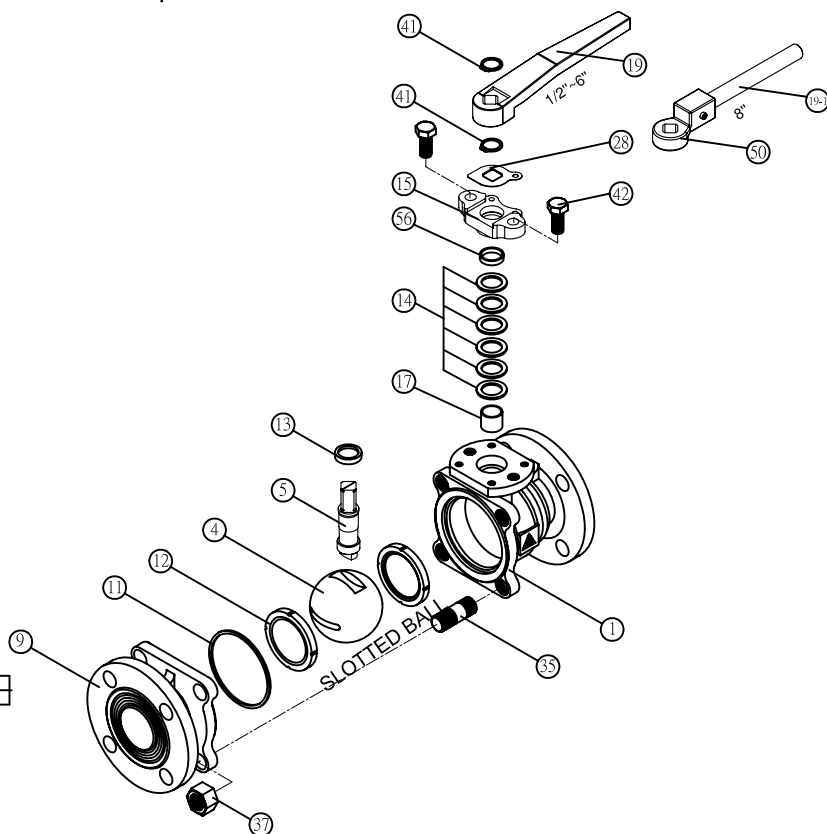
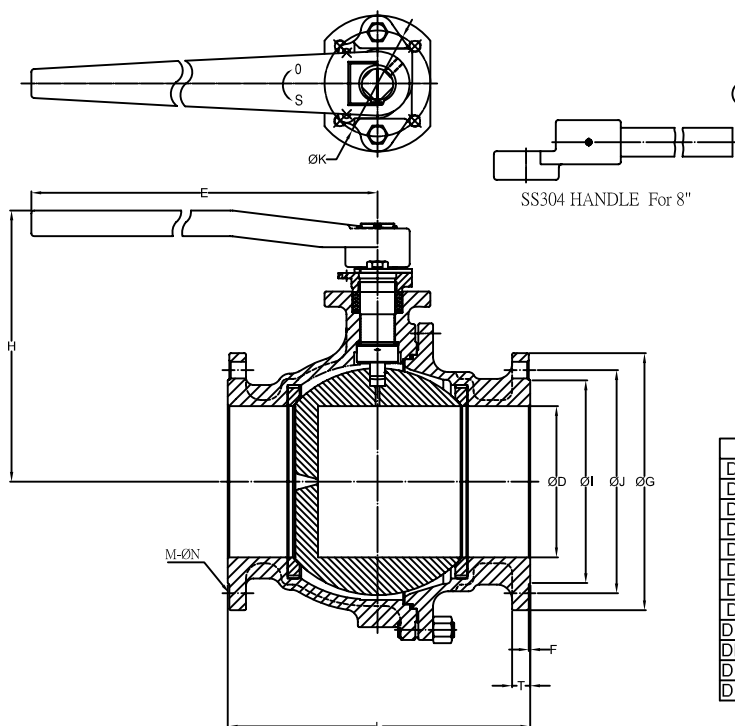

**DIMENSIONS**

| SIZE  | PORT   | L     | E     | H     | ØG    | ØJ    | ØI    | T     | F    | M   | ØN | ØK   |       |
|-------|--------|-------|-------|-------|-------|-------|-------|-------|------|-----|----|------|-------|
| DN15  | 1/2"   | 15.0  | 108.0 | 130.8 | 77.7  | 89.0  | 60.5  | 35.0  | 11.6 | 2.0 | 4  | 16.0 | 42.0  |
| DN20  | 3/4"   | 20.0  | 117.0 | 130.8 | 80.2  | 98.0  | 70.0  | 43.0  | 11.6 | 2.0 | 4  | 16.0 | 42.0  |
| DN25  | 1"     | 25.4  | 127.0 | 163.0 | 92.1  | 108.0 | 79.5  | 51.0  | 12.0 | 2.0 | 4  | 16.0 | 50.0  |
| DN32  | 1-1/4" | 32.0  | 140.0 | 163.0 | 96.8  | 117.5 | 88.5  | 63.5  | 13.3 | 2.0 | 4  | 16.0 | 50.0  |
| DN40  | 1-1/2" | 38.0  | 165.0 | 202.0 | 130.4 | 127.0 | 98.5  | 73.0  | 15.2 | 2.0 | 4  | 16.0 | 70.0  |
| DN50  | 2"     | 50.0  | 178.0 | 202.0 | 137.9 | 152.0 | 120.5 | 92.0  | 16.3 | 2.0 | 4  | 19.0 | 70.0  |
| DN65  | 2-1/2" | 63.0  | 190.0 | 202.0 | 160.5 | 178.0 | 139.5 | 105.0 | 18.0 | 2.0 | 4  | 19.0 | 70.0  |
| DN80  | 3"     | 80.0  | 203.0 | 323.5 | 174.7 | 190.5 | 152.5 | 127.0 | 19.5 | 2.0 | 4  | 19.0 | 102.0 |
| DN100 | 4"     | 98.0  | 229.0 | 323.5 | 197.0 | 229.0 | 190.5 | 157.0 | 24.3 | 2.0 | 8  | 19.0 | 102.0 |
| DN125 | 5"     | 125.0 | 356.0 | 752.5 | 159.3 | 254.0 | 216.0 | 186.0 | 24.5 | 2.0 | 8  | 22.0 | 125.0 |
| DN150 | 6"     | 152.0 | 394.0 | 752.5 | 182.3 | 279.0 | 241.5 | 216.0 | 25.8 | 2.0 | 8  | 22.0 | 125.0 |
| DN200 | 8"     | 200.0 | 457.0 | 839.3 | 241.6 | 343.0 | 298.5 | 270.0 | 29.1 | 2.0 | 8  | 22.0 | 140.0 |